

Proposed Traffic Signal Junction Area In Detail

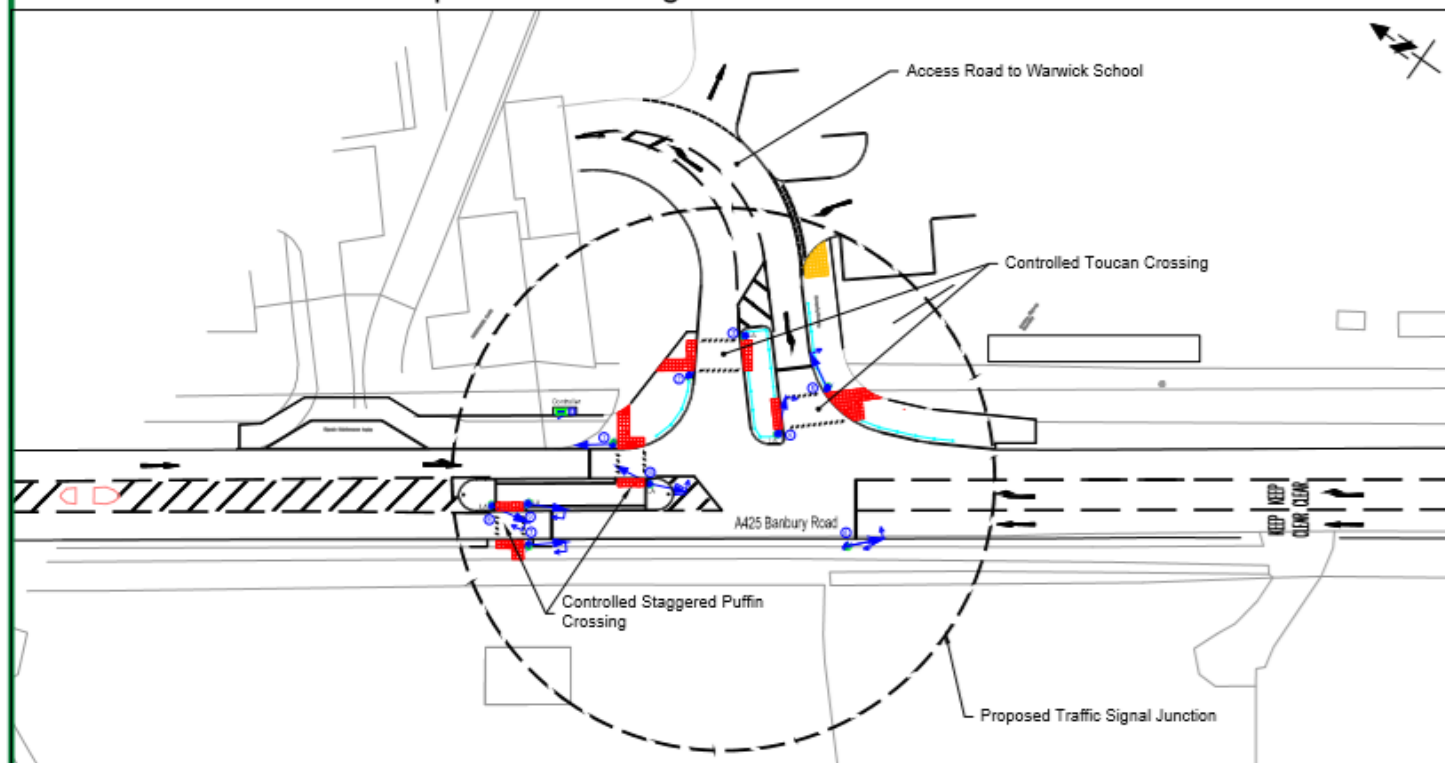

Key

-  Traffic signal head mounted on pole
-  Traffic Signal Controller Approximate dimensions:
73cm width x 43cm depth x 116cm height
-  Traffic Signal Controller Feeder Pillar (FP)
Approximate dimensions:
36cm width x 25cm depth x 60cm height
-  Red Tactile Paving
-  Buff Tactile Paving
-  Guardrails

NOTES

All traffic signal equipment and road markings shown are indicative and may be subject to change during installation due to site constraints.

REV	DRN	AMENDMENT	DATE
-----	-----	-----------	------



Design Services

Design Services
Environment Services, Communities
Shire Hall Post Room
Warwick
CV34 4BP
Tel : 01926 410410
Web : www.warwickshire.gov.uk



FS 26655

C:\DesignServices\24236113 Drawings\3-01 AutoCAD\2423-261-006.dwg

PROJECT

A425 - Banbury Road/Access Rd, Warwick
Proposed Traffic Signal Junction

TITLE

Public Notice Plan

Purpose of Drawing: Consultation

Drn	EM	CK'd	GD	App'd	GD
Date	13-06-19	Date	13-06-19	Date	13-06-19

Status **Approved (Level 3)**

Scale **1:500** Sheet size **A3**

DRG. NO. **24.2---261-006** Rev. **-**